

RF14848

Frisbi E26 Lampholder



WARNING! When installing and whenever acting on the appliance, ensure that the power supply has been switched off.
For the installation of the spare-part, it is necessary to consult a qualified electrician.

RF14848

Frisbi E26 Lampholder



WARNING! When installing and whenever acting on the appliance, ensure that the power supply has been switched off.

For the installation of the spare-part, it is necessary to consult a qualified electrician.

Remove the Plexiglas diffuser (B) by unhooking the steel suspension wires from the "tige" rod clamp (A). Unfasten the ceiling rose screw and then disconnect the lamp electrical wires from the electrical terminal box;

WARNING!!! During this operation it is necessary to hold the "tige" rod and reflector with one hand to avoid causing damages towards people or objects.

WARNING! When installing and whenever acting on the appliance, ensure that the power supply has been switched off.
For the installation of the spare-part, it is necessary to consult a qualified electrician.

RF14848

Frisbi E26 Lampholder

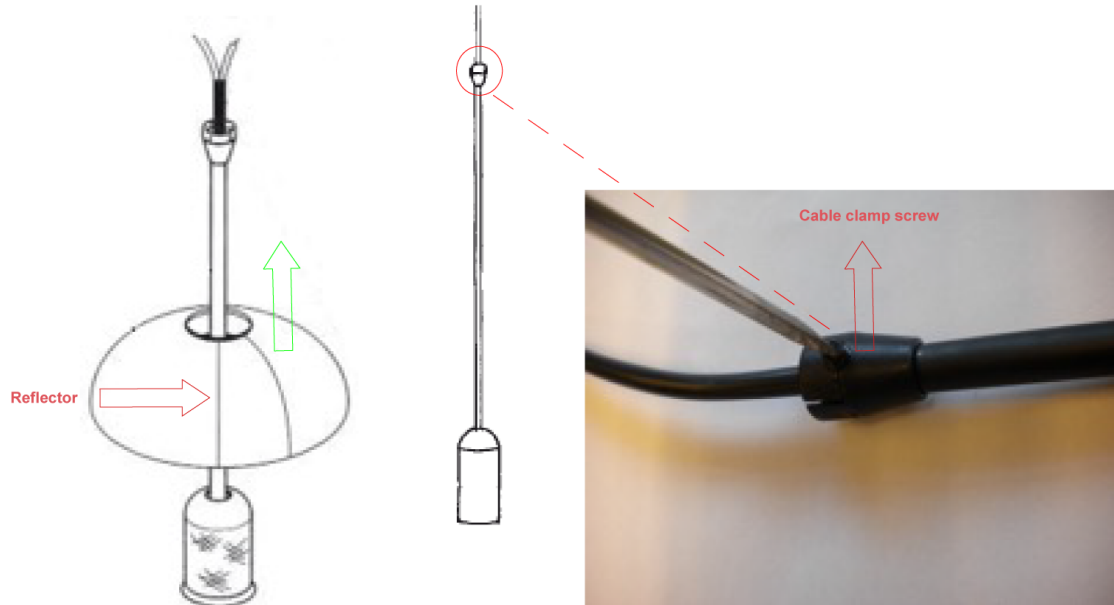

Remove the electrical cable from the wall attachment and ceiling rose and then remove the reflector from the "tige" rod.

Unfasten the cable clamp screw present on the suspension cable clamp of the "tige" rod in a way to free the electrical cable from the rod assemble.

WARNING! When installing and whenever acting on the appliance, ensure that the power supply has been switched off.
For the installation of the spare-part, it is necessary to consult a qualified electrician.

RF14848

Frisbi E26 Lampholder

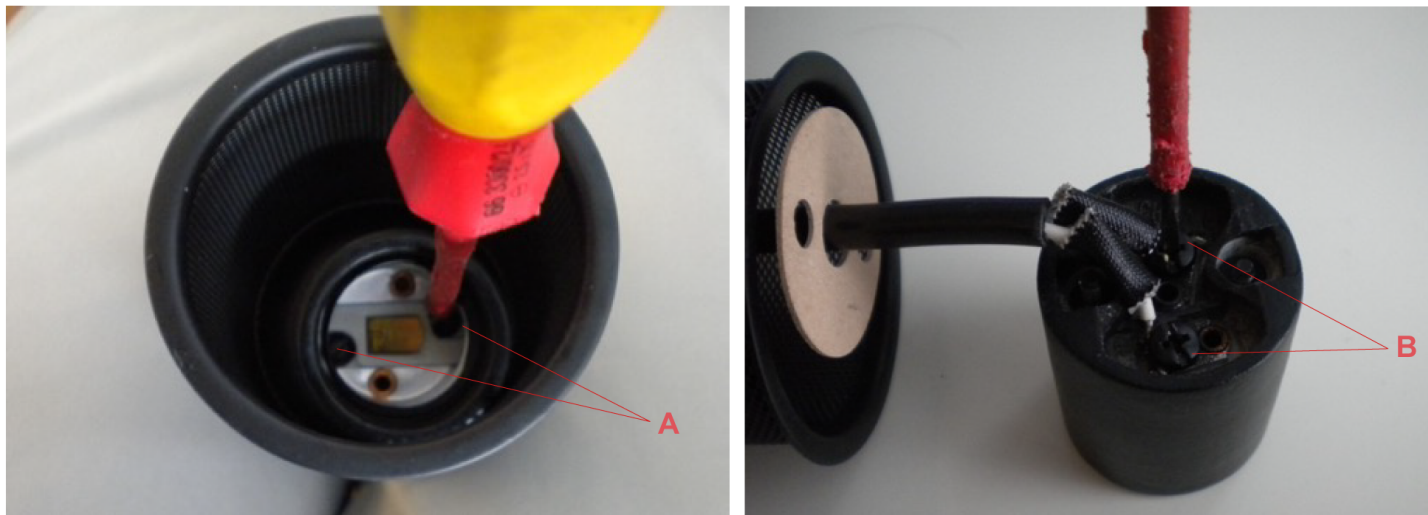

Unfasten the 2 screws (A) of the lampholder.

Pull-up the lampholder and disconnect the wires from the lampholder by unfastening the terminal screws (B).

WARNING! When installing and whenever acting on the appliance, ensure that the power supply has been switched off.
For the installation of the spare-part, it is necessary to consult a qualified electrician.

RF14848

Frisbi E26 Lampholder

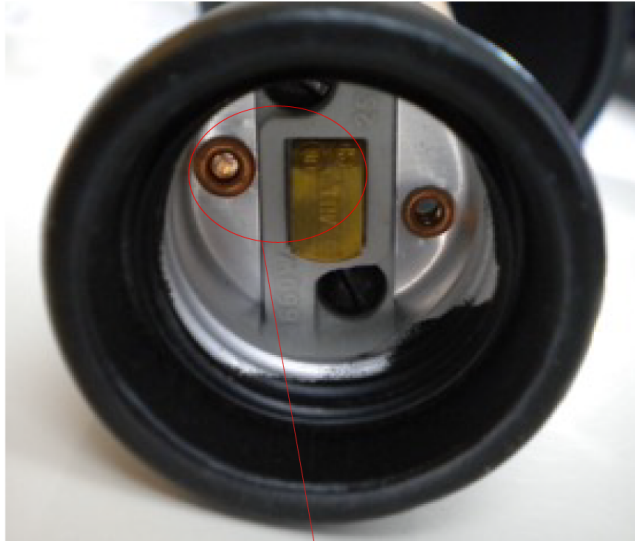

Brass contact of the lampholder

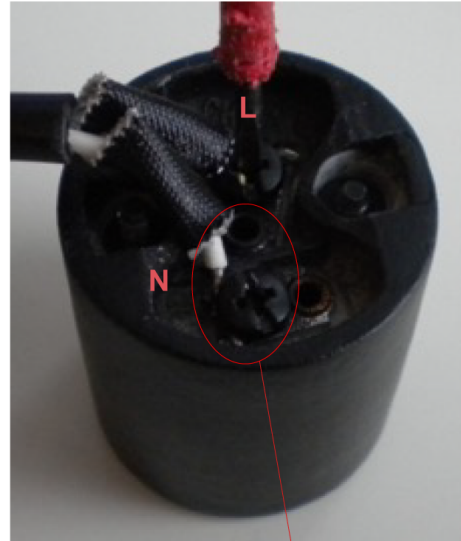

Electrical terminal

Assemble now the new spare-part:

Connect the electrical wires to the new lampholder. Connect the Black "L" (live) wire in the terminal that corresponds (opposite side) with the centre brass contact of the lampholder and then connect the White "N" (neutral) wire in the other terminal.

WARNING! When installing and whenever acting on the appliance, ensure that the power supply has been switched off. For the installation of the spare-part, it is necessary to consult a qualified electrician.

RF14848

Frisbi E26 Lampholder

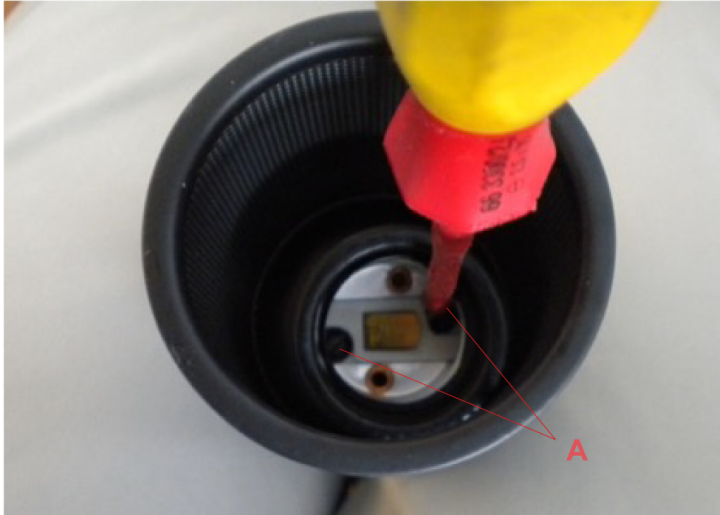

At this point fix back the lampholder to its apposite support by fastening the 2 screws (A).

Tighten back the screw of the cable clamp present on the top side of the "tige" rod.

Install the lamp back on to ceiling and verify the functioning of the fixture (refer to the installation sheet).

WARNING! When installing and whenever acting on the appliance, ensure that the power supply has been switched off.
For the installation of the spare-part, it is necessary to consult a qualified electrician.