

265 CHROMATICA
A0300099

EN

RF31193

MATT GREY TRIANGLE BRACKET SUPPORT

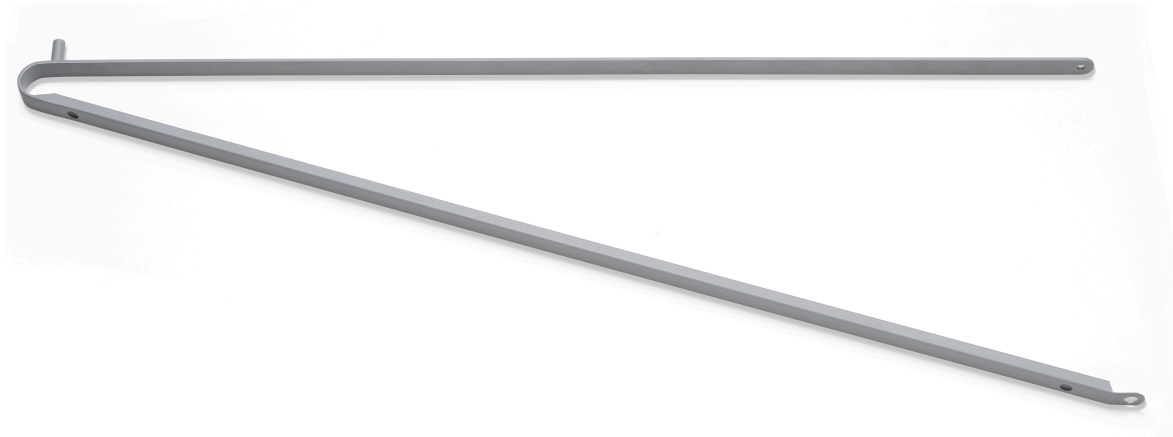

WARNING! When installing and whenever acting on the appliance, ensure that the power supply has been switched off.
For the installation of the spare-part, it is necessary to consult a qualified electrician.

©2021 Flos - All rights reserved - www.flos.com
Flos reserves the right to introduce any changes to its own models, without prior notice.

265 CHROMATICA
A0300099

EN

RF31193

MATT GREY TRIANGLE BRACKET SUPPORT

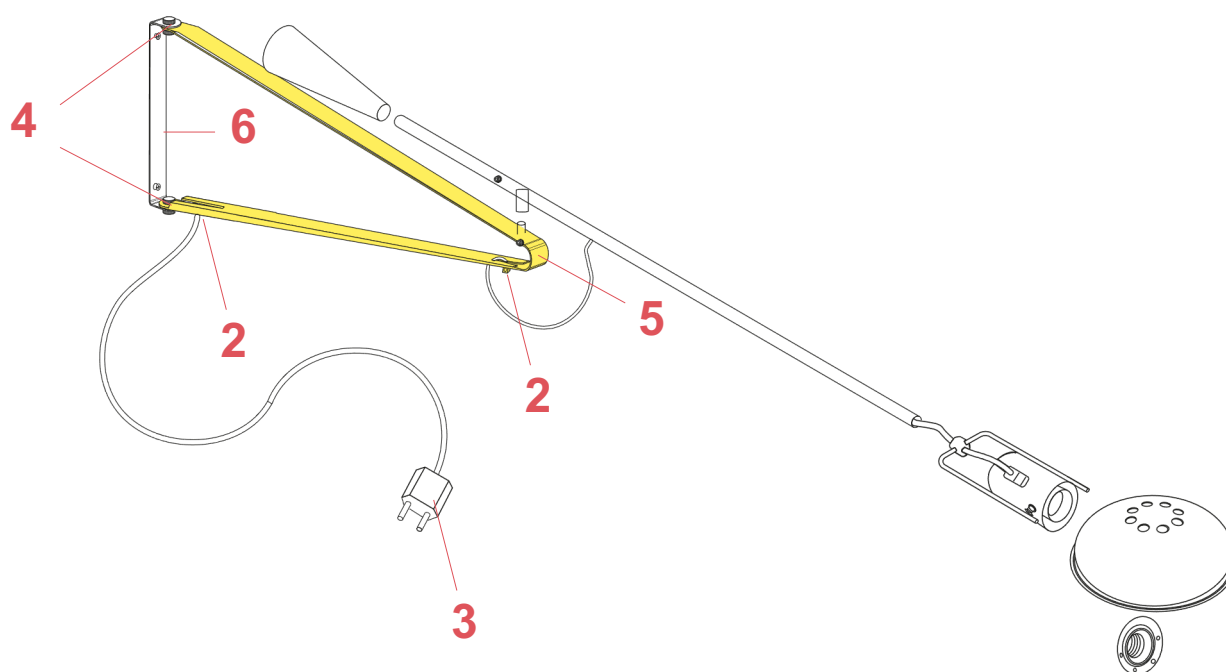

Fig.1

To assemble the triangle stem support (highlighted in yellow in the image), it is necessary:

Disconnect the wires in the plug (3) in a way to free the cable from the plug;

Remove the triangle support (5) from the wall attachment (6) by unfastening the upper and lower screws (4);

Unfasten the two cable clamps (2) screws and slide the electrical cable out from the cable clamps on the triangle support.

Replace the triangle support and re-assemble back all the components.

WARNING! When installing and whenever acting on the appliance, ensure that the power supply has been switched off.
For the installation of the spare-part, it is necessary to consult a qualified electrician.