

## MINI GLO-BALL C/W

Designed by Jasper Morrison, 2002

F4190009

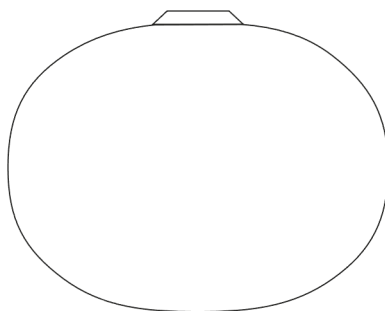

## MINI GLO-BALL C/W

F4190009

EN

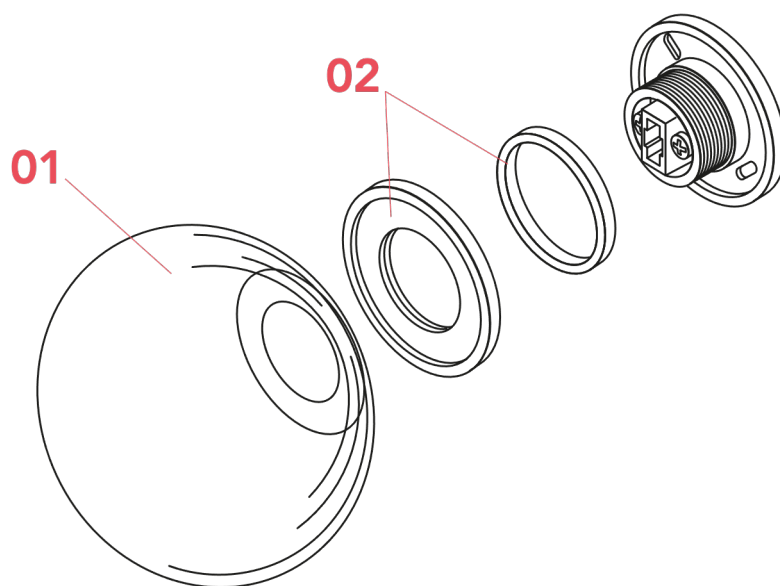

**01. RF4190400** – New type Mini Glo-ball diffuser assembly

**02. RF4190300** – Kit with ring nut & gasket

MINI GLO-BALL C/W F4190009

EN

## RF4190400

MINI GLO-BALL DIFFUSER ASSEMBLY



Mini Glo-ball  
C/W  
p.03



Mini Glo-ball  
T  
p.03

WARNING! When installing and whenever acting on the appliance, ensure that the power supply has been switched off.  
For the installation of the spare-part, it is necessary to consult a qualified electrician.

MINI GLO-BALL C/W F4190009

EN

**RF4190400**

MINI GLO-BALL DIFFUSER ASSEMBLY

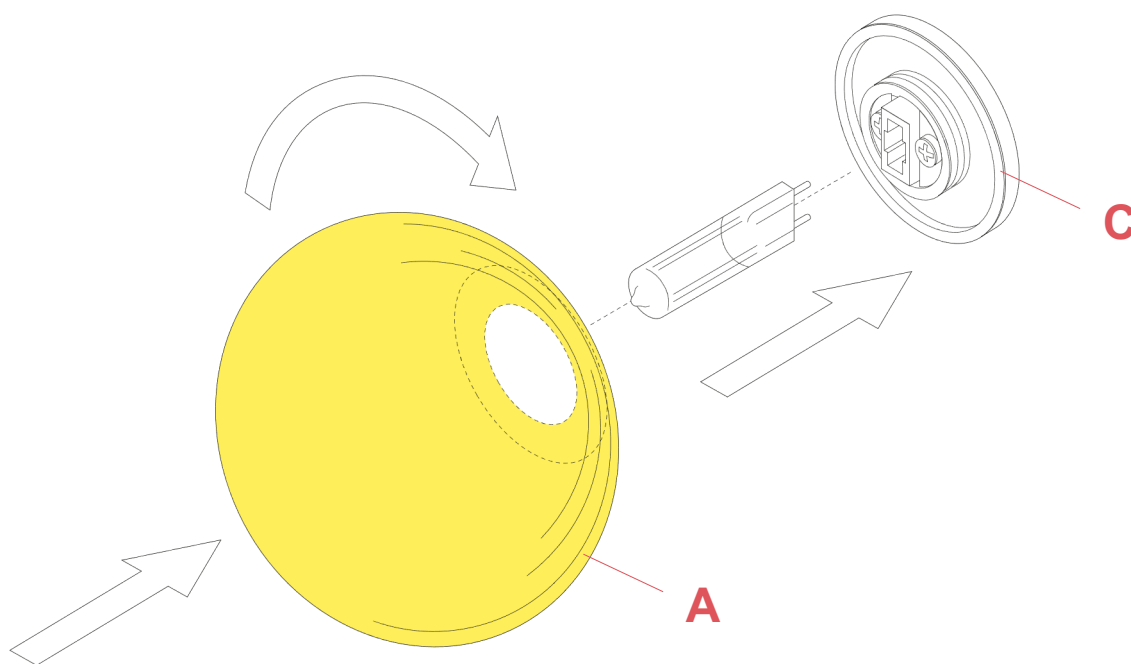

Fig.1

Fasten the diffuser (A) to the lamp body (C).

WARNING! When installing and whenever acting on the appliance, ensure that the power supply has been switched off.  
For the installation of the spare-part, it is necessary to consult a qualified electrician.

MINI GLO-BALL C/W F4190009

EN

## RF4190300

KIT WITH RING NUT & GASKET

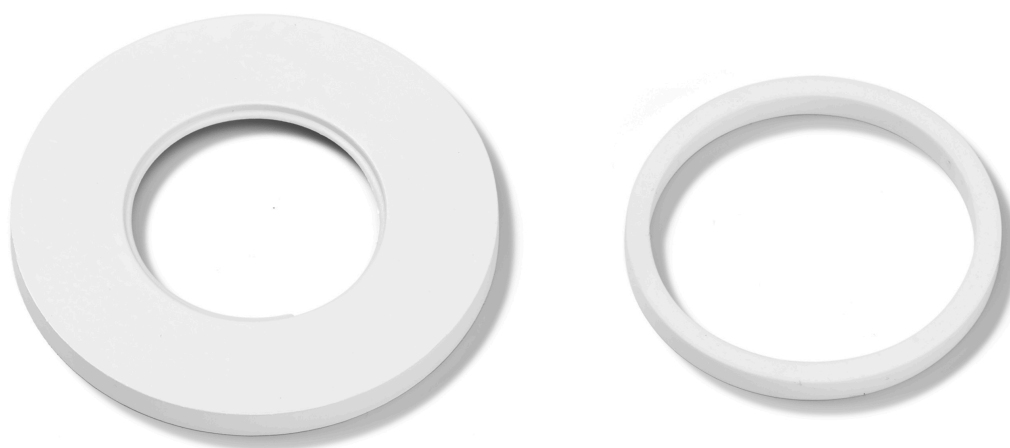

WARNING! When installing and whenever acting on the appliance, ensure that the power supply has been switched off.  
For the installation of the spare-part, it is necessary to consult a qualified electrician.

©2021 Flos - All rights reserved - [www.flos.com](http://www.flos.com)  
Flos reserves the right to introduce any changes to its own models, without prior notice.

MINI GLO-BALL C/W F4190009

EN

**RF4190300**

KIT WITH RING NUT &amp; GASKET

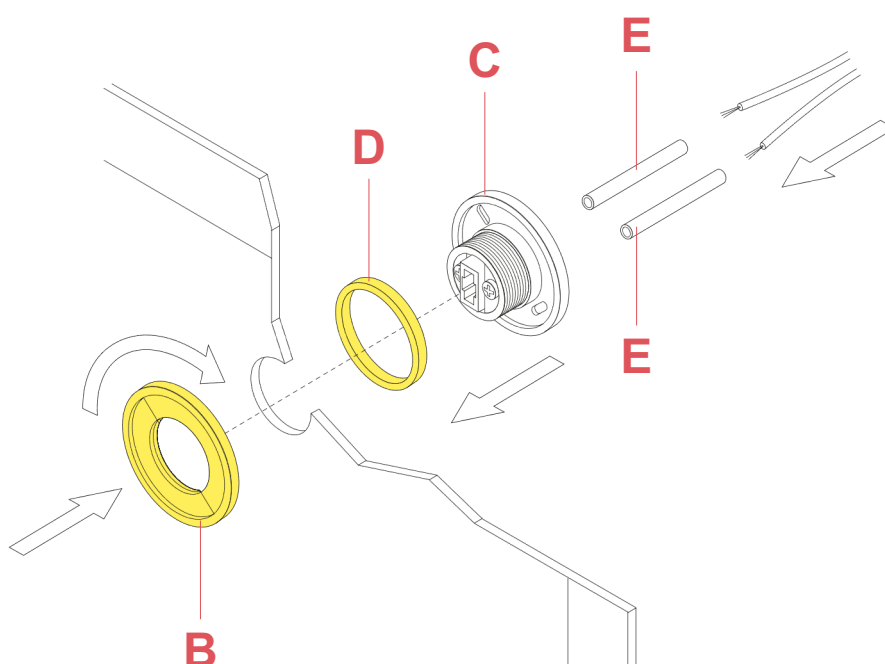

Fig.1

Sheath the feed wires with the provided sheaths (E). Connect the electrical wires in the light bulb holder making sure to connect them correctly in respect of the poles (L = Phase, N = Neutral); fix the body (C) to the mirror screwing the metal ring (B) taking care to position the gasket (D) onto the body itself as indicated in the diagram. Warning: the fixture is suitable for assembly on mirrors with a minimum thickness of 3 mm and a maximum thickness of 6 mm..

WARNING! When installing and whenever acting on the appliance, ensure that the power supply has been switched off. For the installation of the spare-part, it is necessary to consult a qualified electrician.