

**RF4190300**

Ring nut &amp; gasket kit

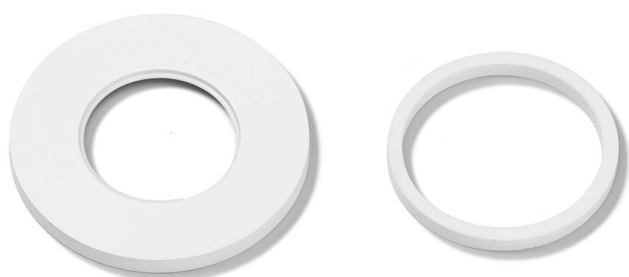

WARNING! When installing and whenever acting on the appliance, ensure that the power supply has been switched off.  
For the installation of the spare-part, it is necessary to consult a qualified electrician.

**RF4190300**

Ring nut &amp; gasket kit

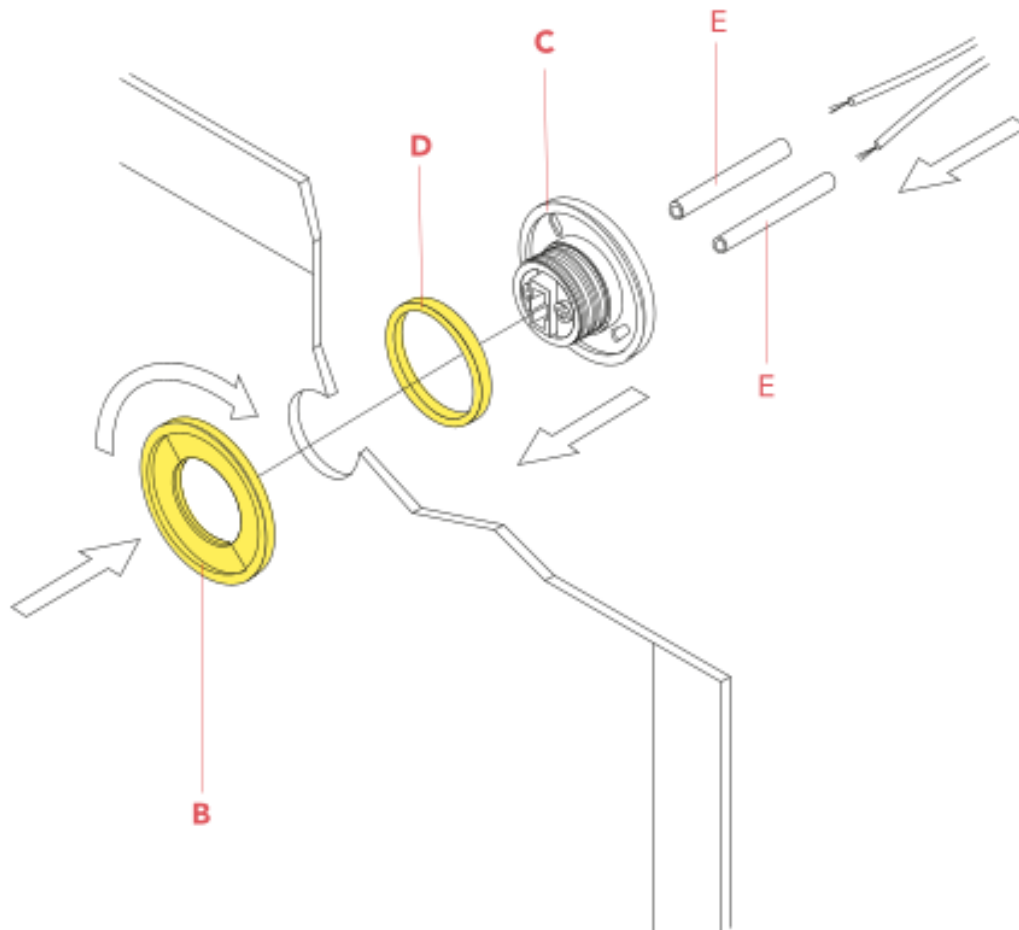
**Fig.1**

Sheath the feed wires with the provided sheaths (E). Connect the electrical wires in the light bulb holder making sure to connect them correctly in respect of the poles (L = Phase, N = Neutral); fix the body (C) to the mirror screwing the metal ring (B) taking care to position the gasket (D) onto the body itself as indicated in the diagram. Warning: the fixture is suitable for assembly on mirrors with a minimum thickness of 3 mm and a maximum thickness of 6 mm.

**WARNING!** When installing and whenever acting on the appliance, ensure that the power supply has been switched off. For the installation of the spare-part, it is necessary to consult a qualified electrician.